

The Right Workstation Makes All The Difference

Revit Performance Wherever Work Takes You



Lenovo

Get the most out of Autodesk® Revit® with the right workstation

Autodesk Revit Building Information Modeling (BIM) software helps architecture, engineering, and construction (AEC) teams create high-quality buildings and infrastructure. Featuring purpose-built tools for architectural design, mechanical, electrical & plumbing (MEP), structural engineering, and construction workflows - Revit supports a multidisciplinary, collaborative design process.

With Revit, you can take an idea from conceptual design to construction documentation within a single software environment. Design and optimize building performance, intelligent structure models and MEP systems that coordinate seamlessly with structural components. Create stunning visualizations for client reviews and public involvement.

Lenovo Workstations are certified for success

Every power-packed Lenovo Workstation, from high-performing towers to mobile workstations, is ISV-tested and certified with Revit and other Autodesk AEC solutions. In the architecture, engineering and construction industries, professionals rely on Lenovo's trusted ThinkStation and ThinkPad workstation solutions with Intel® Core™ and Xeon® processors and NVIDIA RTX™ professional graphics to ensure maximum efficiency, productivity, and ROI.

Revit certification gives you the edge



Quick processing, response, and loading of Revit data sets



Fast graphics and exceptional user experience



Superior and reliable hardware support



Revit features remain enabled and updated





Recommended Lenovo Workstations

Revit and AutoCAD*

3D BIM and 2D Documentation

- ✓ General BIM
- ✓ MEP
- ✓ 2D Documentation
- ✓ Structural Engineering

ThinkStation P3 Family



- » Up to Intel vPro® with 13th Gen Intel Core i9 (24 cores, 5.8GHz)
- » Up to NVIDIA RTX™ 5000 Ada
- » Up to 128GB DDR5, 5600MHz
- » Up to 10TB PCIe M.2 Storage
- » 3-Year Warranty



ThinkPad P16v

For designers and engineers who need high performance 2D CAD on the go.

- » Up to Intel vPro with 13th Gen Intel Core i9 H-Series (14 cores 5.4GHz)
- » Up to NVIDIA RTX 2000 Ada Mobile
- » Up to 96GB DDR5 5600MHz
- » Up to 4TB M.2 PCIe Gen4 NVMe SSD
- » 16" UHD+, IPS, 800nit, Dolby Vision
- » 3-Year Warranty

*available separately from Autodesk or as part of the Autodesk AEC collection

Autodesk AEC Collection

A collection of integrated BIM tools for building design, civil infrastructure, and construction

- Revit - Large BIM Models ✓
- Navisworks - Construction Review & Coordination ✓
- 3ds Max - Visualization & Rendering ✓
- Civil 3D & Infravorks - Infrastructure Design ✓

ThinkStation P5

(Small Businesses & Enterprise)

- » Intel Xeon W-2400 (up to 24 cores, 4.8GHz)
- » Up to 2 NVIDIA RTX A6000
- » Up to 512GB DDR5, 4800MHz
- » Up to 12TB PCIe M.2 Storage
- » 3-Year Warranty



ThinkPad P1

- » Up to Intel vPro with 13th Gen Intel Core i9 H-Series (14 cores, 5.4GHz)
- » Up to NVIDIA RTX 5000 Ada Mobile
- » Up to 96GB DDR5 5600MHz
- » Up to 8TB M.2 PCIe Gen4 NVMe Performance SSD
- » 16" UHD+, OLED Touch, Dolby Vision, HDR400
- » 3-Year Warranty

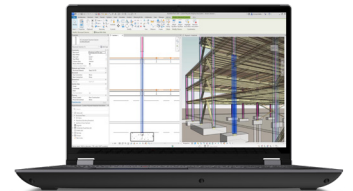

ThinkPad P16

- » Up to Intel vPro with 13th Gen Intel Core i9 HX-Series (24 cores, 5.6GHz)
- » Up to NVIDIA RTX 5000 Ada Mobile
- » Up to 192GB DDR5 5600MHz
- » Up to 8TB M.2 PCIe Gen4 NVMe performance SSD
- » 16" UHD+, OLED Touch, Dolby Vision, HDR500
- » 3-Year Warranty

Lenovo

Recommended Displays



ThinkVision P32p

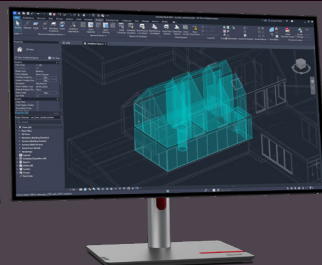

ThinkVision P27u

ThinkVision P27u | ThinkVision P32p

- 27 and 32-inch, 4K UHD (3840 x 2160) IPS
- Professional grade color with 99.5% Adobe® RGB Gamut
- Near-edgeless display
- Pre-calibrated accuracy

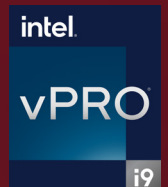

Visit www.lenovo.com/workstations for additional details on Lenovo Workstations.